

A6000484 White (RAL9002)
LED module: 12.4W 1338lm 3000K
warm white
DALI-2
Version 2
Size 4
Covered mounting detail
Flush mounting is possible with
accessory
Darklight lens wide flood

Product description
Housing: cast aluminium, black
powder-coated, designed as heat sink,
with connection cable L 850mm. 0°-30°
tilt. Fixing ring: polymer, black,
rotatable through 360°.
Mounting ring: Polymer, white
(RAL9002). Expanding spring fixing for
ceiling thicknesses of 1-25mm.
4-pole terminal block.
Includes ERCO DALI control gear.
LED module: high-power LEDs.
Collimating lens made of optical
polymer.
Cover: Polymer, white (RAL9002).
Lens Unit: Size S, polymer, white.
Darklight lens made of optical polymer.
Optical cut-off 40°.
Dimming possible via commercially
available push-buttons (Push Dim).
Approved for use as emergency lighting
according to IEC / EN 60598-2-22.
Protection Class II
Weight 0.66kg
Through-wiring possible on request.

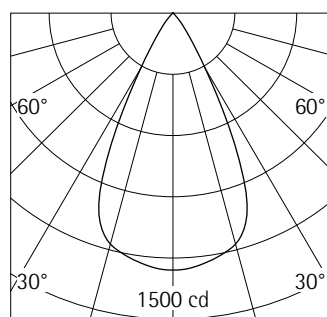

h(m)	E(lx)	D(m)
		52°
1	1259	0.98
2	315	1.95
3	140	2.93
4	79	3.90
5	50	4.88

Technical data

Luminous flux of the luminaire	865lm
Connected load	16.1W
Luminaire efficacy	54lm/W
Colour deviation	1.5 SDCM
Colour rendition index	CRI 92
Lumen maintenance (LED manufacturer specifications)	L90/B10 ≤50000h L90 ≤100000h
LED failure rate	0.1% ≤50000h
Dimming range	0.1%-100%
Dimming method	CCR
TLA (Temporal Light Artefacts)	SVM ≤ 0.1; PstLM ≤ 1
LMF	E
Standby power per control gear	0.4W
Luminaires per circuit breaker B16	192

For your regional contact in the ERCO
Sales network click here
www.erco.com/contact

Technical Region: 220-240V 50/60Hz
We reserve the right to make technical
and design changes.
Edition: 24.05.2024
Current version under
www.erco.com/A6000484

Planning data

Melanopic light effect

Art. no.	Spectrum	MR	MDER
A6000484 (direct)	3000K CRI 92	0.53	0.48

MR	Melanopic factor (of luminous radiation) $a_{mel,v}$
MDER	Melanopic Daylight Efficacy Ratio $[\gamma]_{mel,v,D65}$

Multiplying the illuminance with the melanopic daylight efficacy ratio MDER gives the melanopic equivalent daylight illuminance MEDl. (MEDl Melanopic Equivalent Daylight Illuminance $[lx] E_{v, mel, D65} [lx]$).

Extract from the Environmental Product Declaration (EPD)

The entire EPD can be found at: www.erco.com/A6000484

Extrapolation coefficients to convert the reference data from the EPD document for the declared unit

Lighting output	Manufacturing	Distribution	Installation	Use	EoL	Benefits and loads
770	1.007	1.003	1.000	1.000	1.005	1.007

Frequently used EPD data that have already been converted for this article number.

Parameter	Unit	A1-A3	A4	A5	B6	C1	C2	C3	C4	D	Total, excl. D
Results per functional unit											
GWP	kg CO2-eq.	8.55E00	1.60E-01	3.25E-01	2.13E02	0.00E00	4.39E-03	4.74E-01	4.64E-03	-3.41E-01	2.23E02
GWP-biogenic	kg CO2-eq.	-3.08E-01	0.00E00	3.05E-01	0.00E00	0.00E00	0.00E00	0.00E00	0.00E00	0.00E00	-3.00E-03
Results per declared unit											
GWP	kg CO2-eq.	1.41E01	2.64E-01	5.37E-01	3.52E02	0.00E00	7.25E-03	7.83E-01	7.67E-03	-5.62E-01	3.68E02
GWP-biogenic	kg CO2-eq.	-5.08E-01	0.00E00	5.04E-01	0.00E00	0.00E00	0.00E00	0.00E00	0.00E00	0.00E00	-4.00E-03

A1-A3	Manufacturing
A4	Distribution
A5	Installation
B6	Use
C1-C4	End of Life
D	Benefits and loads

The data for operating the light (Use B6) refer to the European power source mix. You will find the ERCO EPD Help under Downloads/General planning data.

Cleaning (a)	1				2				3			
Ambient conditions	P	C	N	D	P	C	N	D	P	C	N	D
LMF	0.96	0.94	0.90	0.86	0.93	0.91	0.86	0.81	0.92	0.90	0.84	0.79

Hours of operation (h)	1000	5000	10000	20000	30000	40000	50000
LLMF	1.00	0.99	0.98	0.96	0.94	0.92	0.90
LSF	1	1	1	1	1	1	1

MF	LMFxLLMFxLSF
MF	Maintenance Factor
LMF	Luminaire Maintenance Factor
LLMF	Lamp Lumens Maintenance Factor
LSF	Lamp Survival Factor
P	Room pure
C	Room clean
N	Room normal
D	Room dirty

Data according to regulations

2019/2020/EU supplemented by 2021/341/EU and 2019/2015/EU supplemented by 2021/340/EU Energy Consumption Labelling Ordinance

This product contains a light source of efficiency class E
Due to thermal and photometric properties as well as to protect electronic components from ESD (electrostatic discharge) the light source cannot be changed by the customer.

ID EPREL: 1708845

Model identifier: 3000068489

Download data sheets for control gear and disassembly instructions at www.erco.com/slr

Planning data

Technical data in accordance with international norms and standards

IEC 60598	Luminaires – Part 1+2: general requirements, specific requirements and tests
IEC 62031	LED modules for general lighting – safety requirements
IEC 62471	Photobiological safety of lamps and lamp systems
EN 13032-4	Light and lighting – measurement and representation of photometric data
CIE 13	Method of measuring and specifying colour rendering properties of light sources

All technical data is subject to industry-standard tolerances.

Also see www.erco.com/erco-led

For explanations of the symbols and abbreviations used and other general information, see www.erco.com/symbols

Accessories



AC002006
 Lens unit spot
 Polymer, black lacquered, rotatable through 360°. Replacement without tools.
 Darklight lens made of optical polymer.
 Optical cut-off 50°.
 Weight 0.04kg



AC002003
 Lens unit extra wide flood
 Polymer, black lacquered, rotatable through 360°. Replacement without tools.
 Darklight lens made of optical polymer.
 Weight 0.04kg



AC002038
 Lens unit spot
 Polymer, white, rotatable through 360°. Replacement without tools.
 Darklight lens made of optical polymer.
 Optical cut-off 50°.
 Weight 0.04kg



AC002035
 Lens unit extra wide flood
 Polymer, white, rotatable through 360°. Replacement without tools.
 Darklight lens made of optical polymer.
 Weight 0.04kg



AC002004
 Lens unit flood
 Polymer, black lacquered, rotatable through 360°. Replacement without tools.
 Darklight lens made of optical polymer.
 Optical cut-off 40°.
 Weight 0.04kg



AC002032
 Lens unit oval flood
 Polymer, white, rotatable through 360°. Replacement without tools.
 Anti-reflective Spherolit lens made of optical polymer.
 Weight 0.04kg
 Only in conjunction with AC006065



AC002036
 Lens unit flood
 Polymer, white, rotatable through 360°. Replacement without tools.
 Darklight lens made of optical polymer.
 Optical cut-off 40°.
 Weight 0.04kg

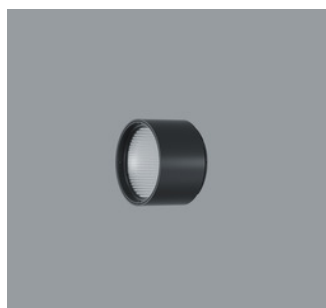

AC002058
 Lens unit oval flood
 Polymer, black lacquered, rotatable through 360°. Replacement without tools.
 Anti-reflective Spherolit lens made of optical polymer.
 Weight 0.04kg
 Only in conjunction with AC006063



AC002002
 Lens unit wide flood
 Polymer, black lacquered, rotatable through 360°. Replacement without tools.
 Darklight lens made of optical polymer.
 Optical cut-off 40°.
 Weight 0.04kg

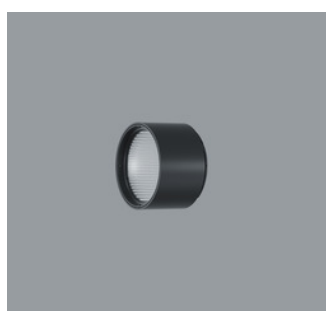

AC002007
 Lens unit oval wide flood
 Polymer, black lacquered, rotatable through 360°. Replacement without tools.
 Anti-reflective Spherolit lens made of optical polymer.
 Weight 0.04kg
 Only in conjunction with AC006063



AC002033
 Lens unit wide flood
 Polymer, white, rotatable through 360°. Replacement without tools.
 Darklight lens made of optical polymer.
 Optical cut-off 40°.
 Weight 0.04kg



AC002039
 Lens unit oval wide flood
 Polymer, white, rotatable through 360°. Replacement without tools.
 Anti-reflective Spherolit lens made of optical polymer.
 Weight 0.04kg
 Only in conjunction with AC006065

Accessories

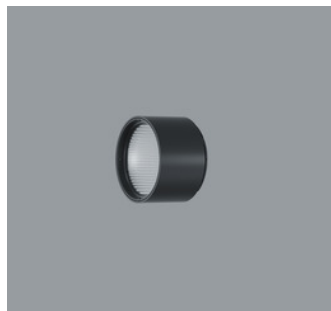

AC002005
Lens unit wallwash
Polymer, black lacquered, rotatable through 360°. Replacement without tools.
Anti-reflective Spherolit lens made of optical polymer.
Weight 0.04kg
Only in conjunction with AC006063

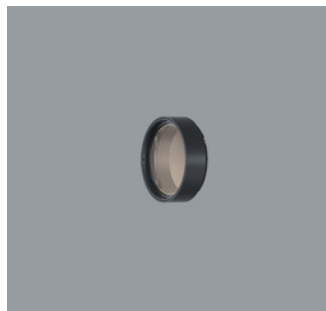

AC006005
Warm Filter
Filter holder: polymer, black, rotatable through 360°. Replacement without tools.
Weight 0.03kg



AC002037
Lens unit wallwash
Polymer, white, rotatable through 360°. Replacement without tools.
Anti-reflective Spherolit lens made of optical polymer.
Weight 0.04kg
Only in conjunction with AC006065

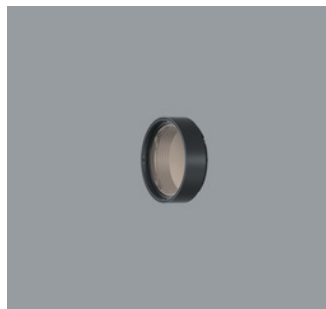

AC006003
Warm Filter Plus
Filter holder: polymer, black, rotatable through 360°. Replacement without tools.
Weight 0.03kg

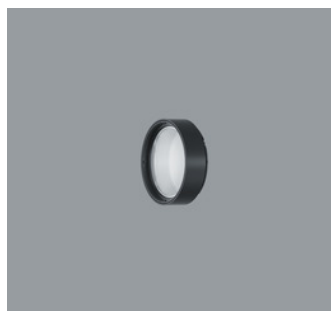

AC006002
Softening lens
Filter holder: polymer, black, rotatable through 360°. Replacement without tools.
Weight 0.03kg

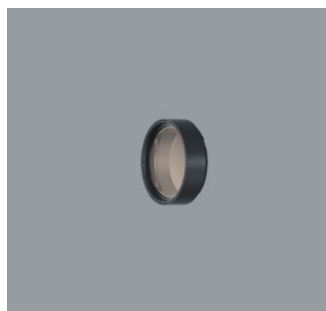

AC006006
Skintone Filter
Filter holder: polymer, black, rotatable through 360°. Replacement without tools.
Weight 0.03kg



AC006025
Sculpture lens
Filter holder: polymer, black, rotatable through 360°. Replacement without tools.
Weight 0.03kg

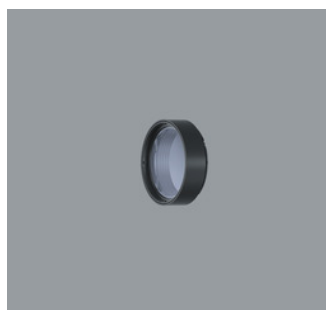

AC006013
Fish Filter
Filter holder: polymer, black, rotatable through 360°. Replacement without tools.
Weight 0.03kg

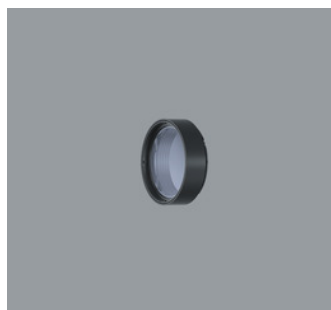

AC006009
Cold Filter
Filter holder: polymer, black, rotatable through 360°. Replacement without tools.
Weight 0.03kg

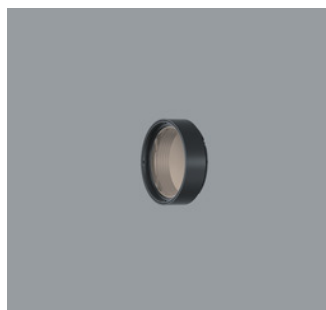

AC006010
Marbled Meat Filter
Filter holder: polymer, black, rotatable through 360°. Replacement without tools.
Weight 0.03kg

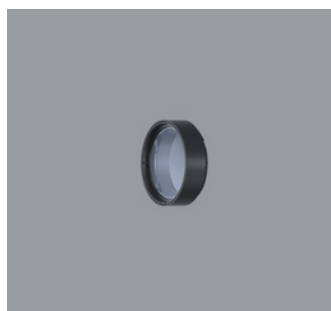

AC006007
Cold Filter Plus
Filter holder: polymer, black, rotatable through 360°. Replacement without tools.
Weight 0.03kg

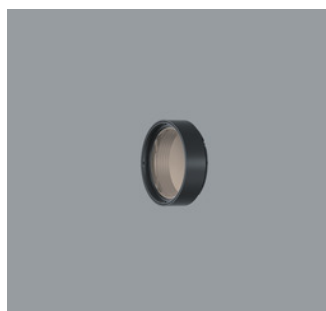

AC006008
Bread and Pastry Filter
Filter holder: polymer, black, rotatable through 360°. Replacement without tools.
Weight 0.03kg

Accessories

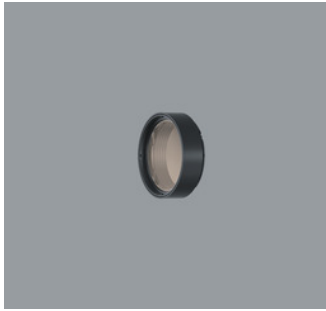

AC006004
Blue Light Filter
Filter holder: polymer, black, rotatable through 360°. Replacement without tools.
Weight 0.03kg



83738.000
Concrete housing
Stainless steel, galvanised/powder-coated. Recommended 0-8mm aggregate for the concrete.
Weight 4.35kg



AC006065
Lens Unit Adapter
Polymer, white, rotatable through 360°. Replacement without tools.
Weight 0.01kg

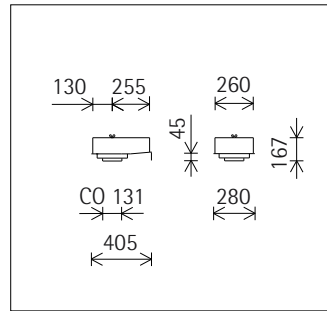

AC006063
Lens Unit Adapter
Polymer, black, rotatable through 360°. Replacement without tools.
Weight 0.01kg



83595.000
Spacer plate
Aluminium.
For flush-mounting of downlights in concrete housings in exposed concrete ceilings.
Weight 0.07kg



AC001002
Snoot
Polymer, black, coated white on outside.
Weight 0.01kg

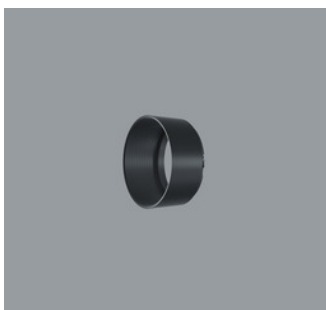
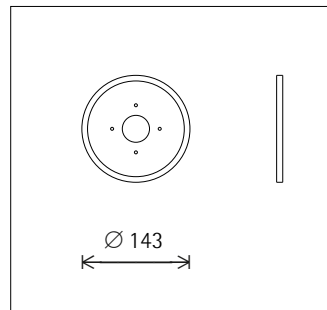

AC001010
Snoot
Polymer, black.
Weight 0.01kg



82936.000
Mounting ring
For flush mounting of recessed luminaires size 4.
Polymer, white (RAL9002). Mounting for ceiling thicknesses of 12.5-25mm. The recess depth of the luminaire increases by 2mm.
Weight 0.10kg



AC004024
Honeycomb anti-glare screen
Black
Weight 0.02kg

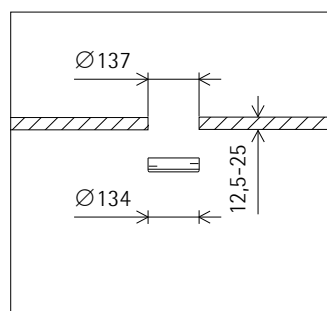

Accessories



82942.000

Mounting ring
For covered mounting of recessed
luminaires size 4.
Polymer, black (RAL9011). Fixing springs
for ceiling thicknesses of 1-25mm.

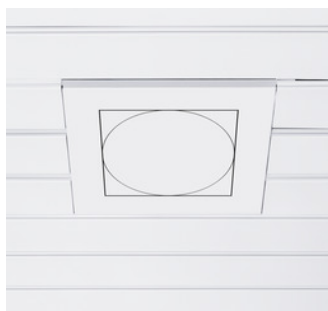
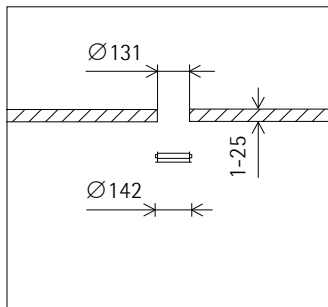

82950.000

Mounting plate for panelled ceilings
Metal, white (RAL9002) powder-coated.
Individual design of mounting plates
according to ceiling type and luminaire.
Quote ceiling type and dimensions.



88290.000

Compensation set
For oversize ceiling cut-out.
Lock ring: Sheet steel, galvanised.
Mounting for ceiling thickness of min.
10mm.
Cover ring: Metal, white.
when ordering, please state the
diameter of the existing ceiling cutout
and the diameter of the luminaire.



83980.000

Cover ring
Metal, white. For covering the gap
where ceiling cut-outs are too big.
Inner and outer diameter to be
specified when placing order.